

04/16/2018

To: Wm. S. Hart Union High School District  
Attn: Mike Otavka, Director of Facilities  
21380 Centre Pointe Parkway,  
Santa Clarita, CA 91350

RE: Saugus HS Auto Shop

Dear Mike,

Please find enclosed our proposal for the upgrades to the Auto Shops as Discussed:

Saugus High School:

**-Provide Electrical engineering** for new lighting and power upgrades. - \$3,450.00

- 1) Automotive Shop Electrical Revisions for Saugus High School.
- 2) One site survey to verify existing conditions.
- 3) Provide three (3) new dedicated 120 or 208 volt receptacles to power new shop equipment.
- 4) Provide 208V connection to new exterior lift from building's main electrical room.
- 5) Provide benchtop convenience outlets.
- 6) Provide benchtop task lighting.
- 7) Provide sheet specification.

**-Provide Structural Engineering**

- 1) Provide structural construction documents and supporting calculations for the following:
  - a. Foundations and anchorage of new auto lift
  - b. Seismic bracing of new pendant light fixtures (two fixture types assumed)
- 2) Assist with obtaining DSA approval including responding to structural review comments and meeting with the Structural Safety plan reviewer as required.
- 3) Provide construction administration services for the project including responding to structural RFI's, reviewing structural submittals, and performing structural observations as required by DSA (2 visits assumed).



### **-Provide Architecture**

- \* Field measure/ Verify equipment sizes/ Research archives.
- \* Meet with shop teacher to review proposed and final layout(s).
- \* Develop background drawing(s) for Electrical/Structural Engineer(s).
- \* Architectural Title Sheet /General Notes, Site Plan, Floor Plan (s) and details
- \* Specifications.
- \* Coordinate Consultants
- \* Construction Administration
- \* DSA Coordination

**Total fee = \$25,400.00**

#### **Payment as follows:**

Phase	%	Fee
Design Development	35	\$8,890
Construction Documents	40	\$10,160
Bid and Approval	15	\$3,810
<b>Construction Administration</b>	<b>10</b>	<b>\$2,540</b>
<b>TOTAL</b>	<b>100%</b>	<b>\$25,400</b>

This proposal is based on our current insurance package. Our fees reflect our current insurance package, which is established to provide our clients meaningful insurance coverage while maintaining moderate engineering fees. (In recognition of the relative risks and benefits of the project to both the client and the design professional, the risks have been allocated such that the client agrees to the maximum extent permitted by law, to limit the design professional's liability for the client's damages to the design professional's fee. This limitation shall apply regardless of the cause of action or legal theory pled or asserted).

### **REIMBURSABLE EXPENSES**

Anticipated expenses for messenger and delivery services, reproduction, printing, plotting and local travel, site visits (elect). All other services, which are considered as additional services (beyond the scope of work noted herein) will be billed on an hourly basis per our standard hourly rates).



Greg Powell  
Principal Architect  
Architecture Plus  
[gpowell.archplusstudio@gmail.com](mailto:gpowell.archplusstudio@gmail.com)

Accepted By: \_\_\_\_\_

Name \_\_\_\_\_

Title \_\_\_\_\_

Date \_\_\_\_\_



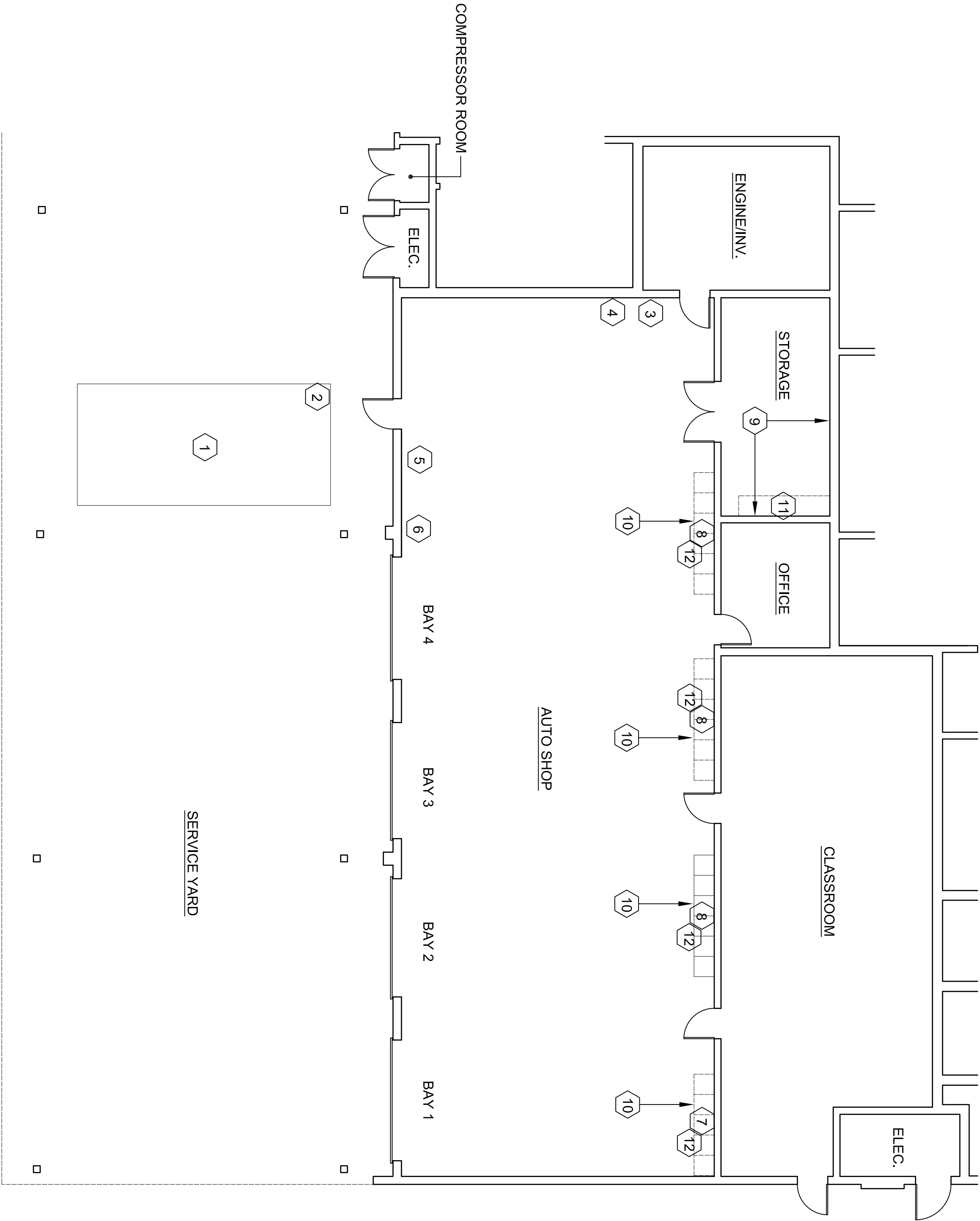

**KEYNOTE LEGEND:**

PROVIDE POWER OR COMPRESSED AIR FOR THE FOLLOWING EQUIPMENT:

- 1 EXIST. AUTO LIFT  
DO NOT REMOVE  
CANNOT BE USED UNTIL LIFT IS  
ATTACHED PROPERLY TO CONC. SLAB.
- 2 P.O.C. FOR AUTO LIFT (208v, 26A, 1p)
- 3 EXIST. PARTS WASHER (115/230v, 11-5A, 1p)
- 4 EXIST. SAND BLASTER (115/120v, 8A, 1p)
- 5 EXIST. TIRE CHANGER (PNEUMATIC ONLY)
- 6 EXIST. WHEEL BALANCER (208v, 10A, 1p)
- 7 EXIST. MOVABLE ALIGNMENT RACK (115/12v, 3.5A, 1p)
- 8 ADD 2 - 115/120v OUTLETS FOR BENCH WORK
- 9 ADD 2 - 115/120v OUTLETS FOR TOOL CHARGING

REMOVE AND/OR RELOCATE THE FOLLOWING EQUIPMENT:

- 10 REMOVE LOCKERS AND RELOCATE. PATCH AND PAINT WALL BEHIND.
- 11 REMOVE WORKBENCH AND SHELVING. PATCH AND PAINT WALL BEHIND.

BUILDING ADDITIONS:

- 12 ADD NEW CEILING MOUNTED PENDANT LIGHT FIXTURES ABOVE WORK AREA.

SCOPE OF WORK  
SAUGUS HIGH SCHOOL AUTO SHOP  
(BUILDING D)  
GRAPHIC  
SCALE 0 2' 4' 8'

